

Richard Washington, License #734  
Expiration Date 12/31/20

your trusted advisor  
consultants  
engineers  
architects  
planners

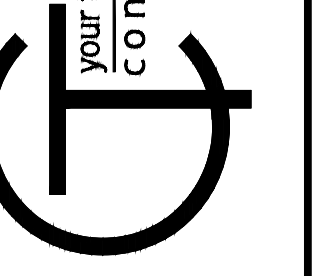

NO	REVISION	DATE

ISSUED FOR:	PRELIM SET
ISSUE DATE: 06/19/20	AS SHOWN
SCALE:	RW
DESIGNED BY:	RW
DRAWN BY:	CC
CHECKED BY:	

**CHARDON 7TH AVE**  
7TH AVE, CHARDON, OH, GEauga COUNTY  
REDWOOD - 7510 EAST PLEASANT VALLEY ROAD  
INDEPENDENCE, OH 44131

**OVERALL SITE LANDSCAPE PLAN**

PROJECT NO:	200623
DISCIPLINE:	LANDSCAPE
SHEET NAME:	L-1
SHEET:	1
OF:	3



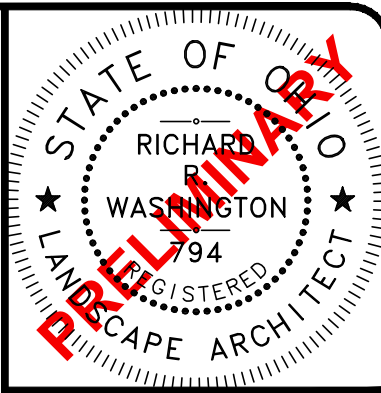

Richard Washington, License #754  
Expiration Date 12/31/20

your trusted advisor  
engineers  
architects  
planners  
consultants

**LEGEND**

- SHADE TREES - 2-1/2" CALIPER  
 RED SUNSET MAPLE, SKYLINE  
 HONEYLOCUST, PRINCETON ELM,  
 BLOODGOOD LONDON PLANETREE
- ORNAMENTAL TREES - 2" CALIPER  
 AUTUMN BRILLIANCE  
 SERVICEBERRY, MILKYWAY  
 CHINESE DOGWOOD, PRAIRIEFIRE  
 CRABAPPLE, SPRING SNOW  
 CRABAPPLE, JAPANESE TREE  
 LILAC
- EVERGREEN TREES - 6" HT.  
 CONCOLOR FIR, WHITE SPRUCE,  
 NORWAY SPRUCE, EASTERN RED  
 CEDAR
- SHRUBS - EVERGREEN  
 GREEN SARGENT JUNIPER, NICKS'  
 COMPACT JUNIPER, GREEN THREAD  
 FALSECYPRESS, DENSE YEW
- SHRUBS - DECIDUOUS  
 ISANTI RED TWIG DOGWOOD,  
 JUNIPER, GOLD FLAME SPIRAEA,  
 TINY WINE NINEBARK, WINTERHUR  
 VIBURNUM
- GRASSES/PERENNIALS - 1 GAL  
 HAPPY RETURNS DAYLILY, CATMINT,  
 CARL FOERSTER REED GRASS,  
 BLACK-EYED SUSAN, ADAGIO MAIDEN  
 GRASS
- EXISTING WOODED AREAS TO REMAIN

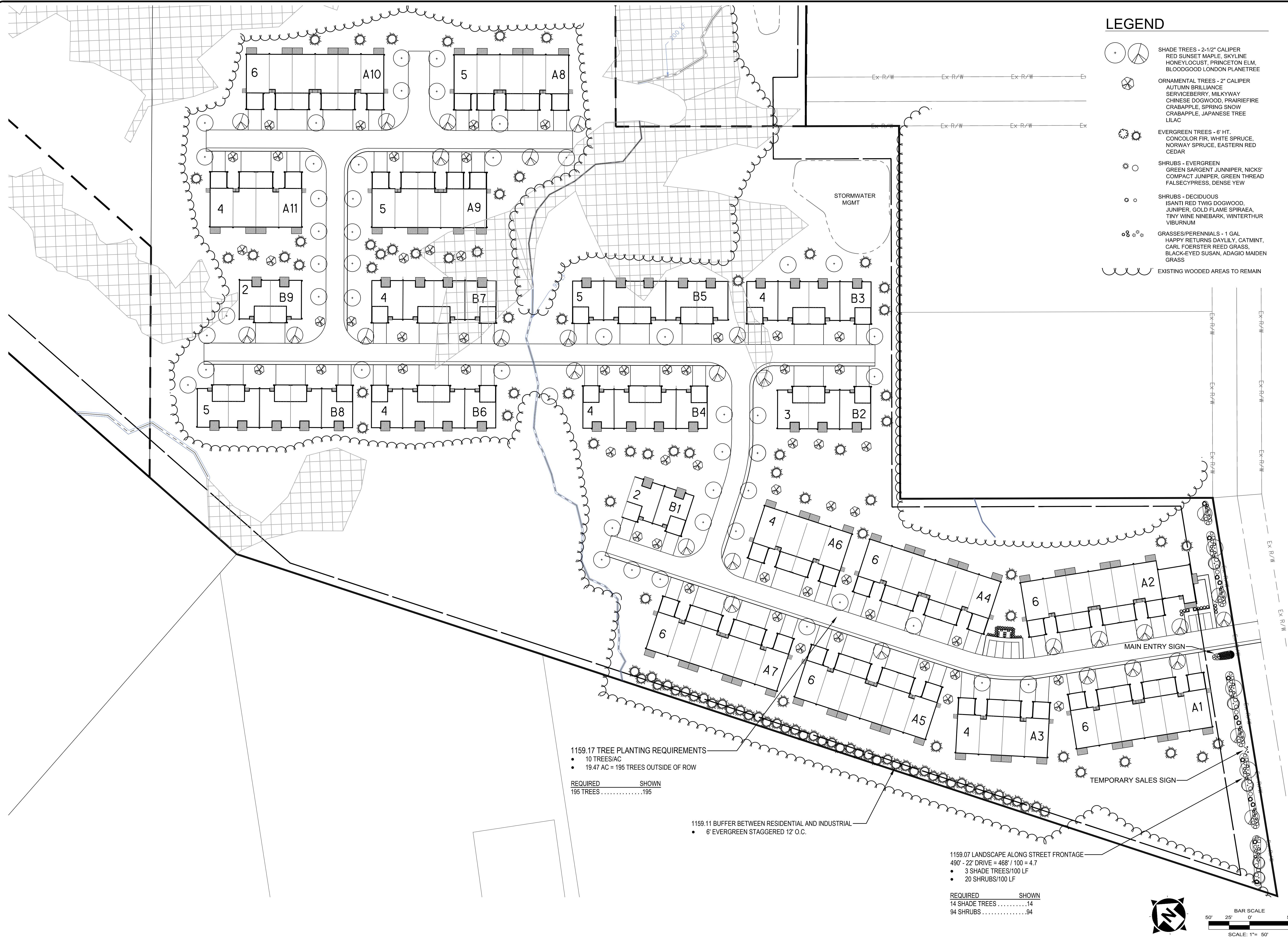

1159.17 TREE PLANTING REQUIREMENTS

- 10 TREES/AC
- 19.47 AC = 195 TREES OUTSIDE OF ROW

REQUIRED	SHOWN
195 TREES	.....195

1159.11 BUFFER BETWEEN RESIDENTIAL AND INDUSTRIAL

- 6' EVERGREEN STAGGERED 12' O.C.

1159.07 LANDSCAPE ALONG STREET FRONTAGE

490' - 22' DRIVE = 468' / 100 = 4.7

- 3 SHADE TREES/100 LF
- 20 SHRUBS/100 LF

REQUIRED	SHOWN
14 SHADE TREES	.....14
94 SHRUBS	.....94

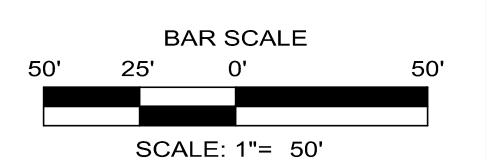
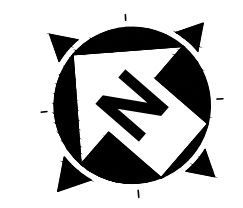

DATE	REVISION	NO	ISSUED FOR:	PRELIM SET	ISSUE DATE:	SCALE:	DESIGNED BY:	DRAWN BY:	CHECKED BY:
					06/19/20	AS SHOWN			

**CHARDON 7TH AVE**  
 7TH AVE, CHARDON, OH, GEauga COUNTY  
 REDWOOD - 7510 EAST PLEASANT VALLEY ROAD  
 INDEPENDENCE, OH 44131

**SITE LANDSCAPE PLAN**

PROJECT NO:	200623
DISCIPLINE	LANDSCAPE
SHEET NAME	L-2
SHEET	2
OF	3

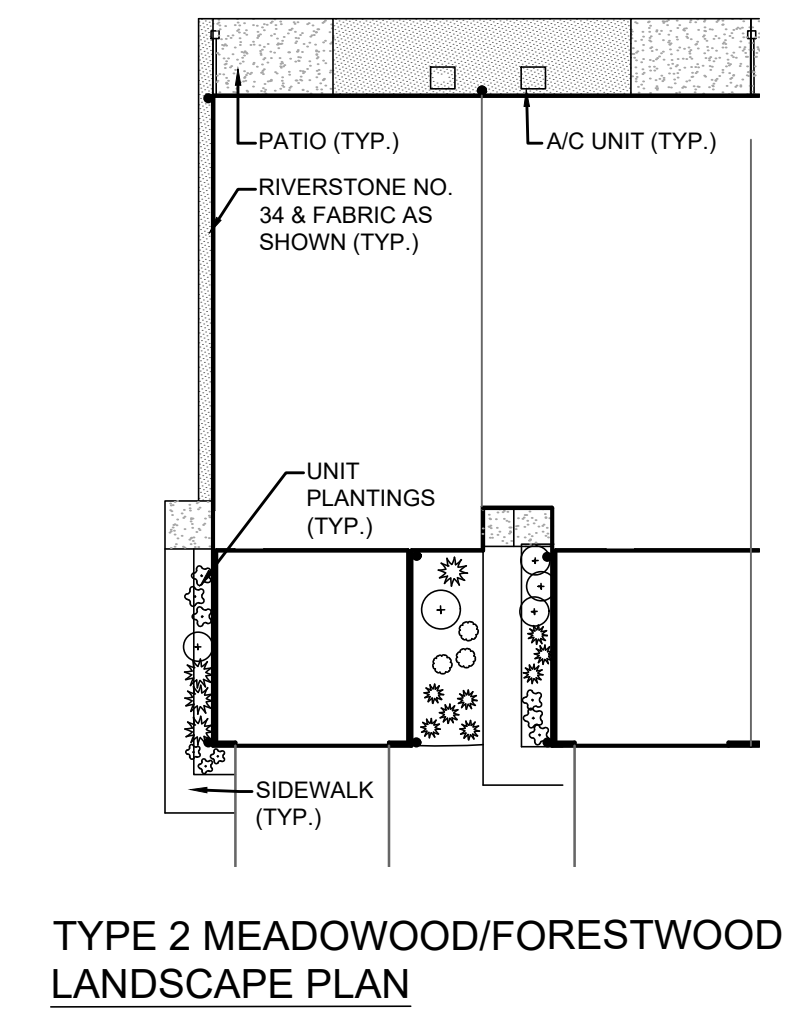

TYPE 2 MEADOWOOD/FORESTWOOD LANDSCAPE PLAN

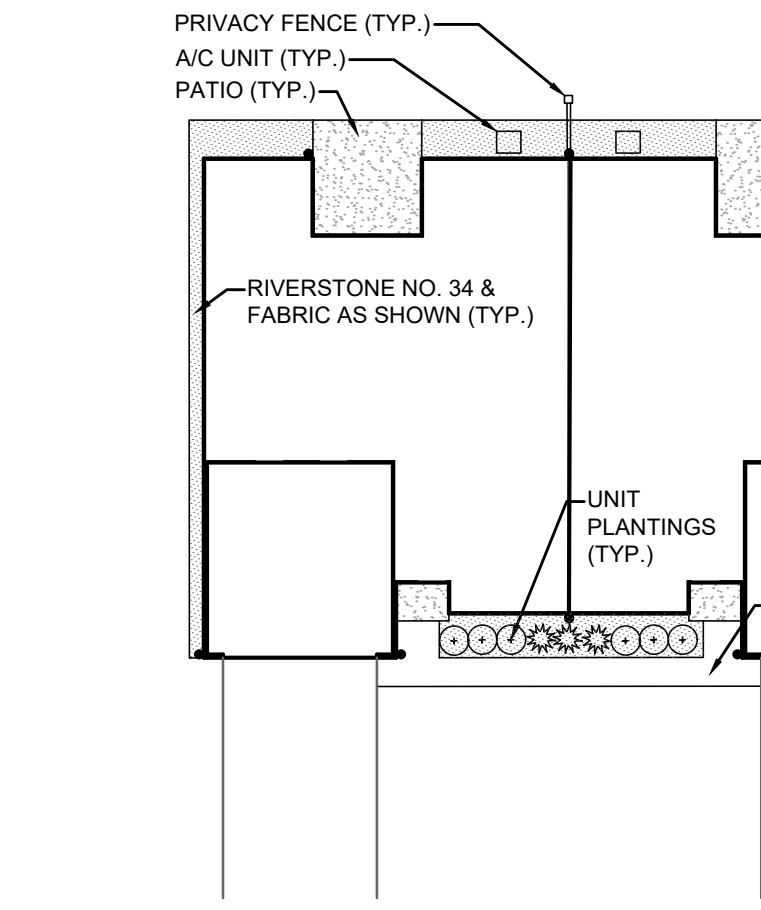

TYPE 7 WILLOWOOD LANDSCAPE PLAN

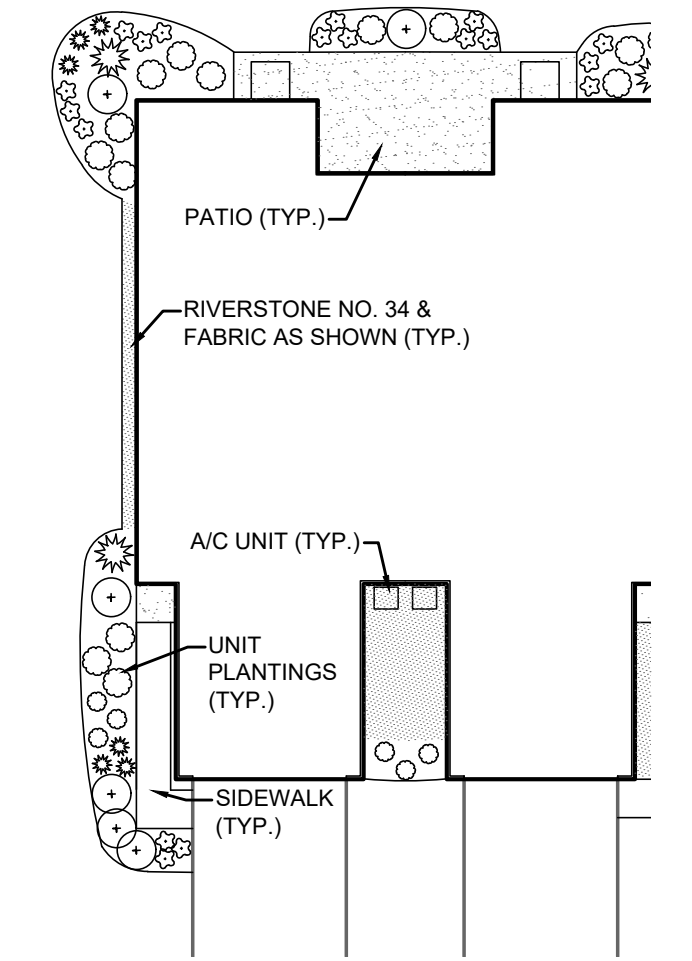

TYPE B HAYDENWOOD LANDSCAPE PLAN

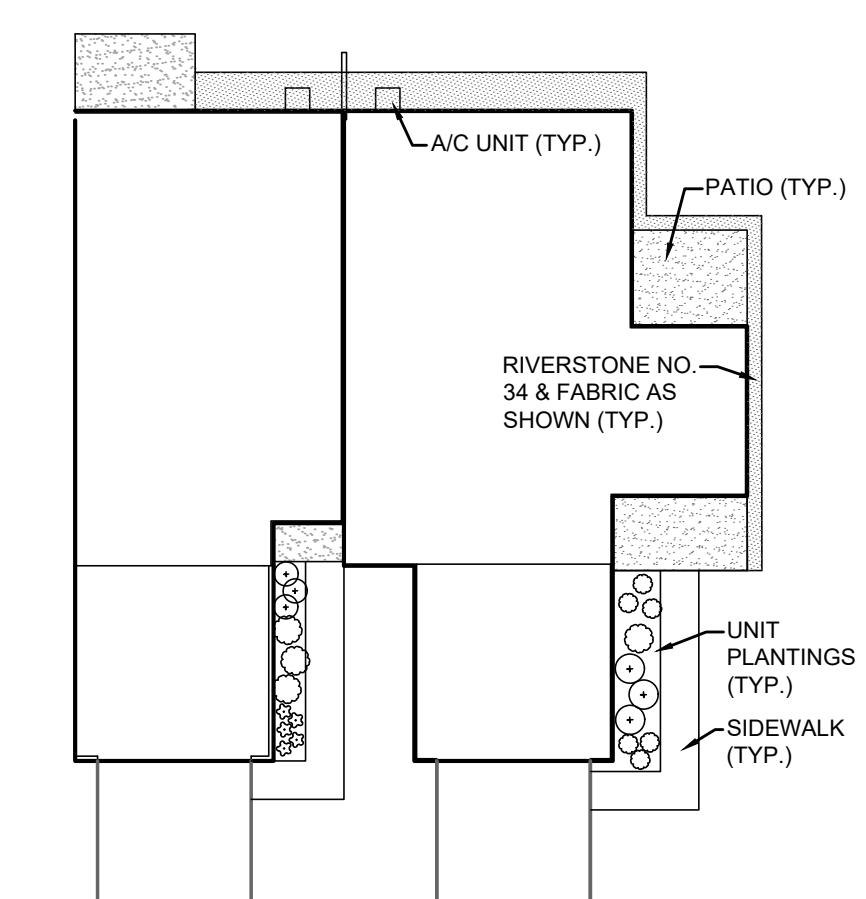

TYPE 10 CAPEWOOD LANDSCAPE PLAN

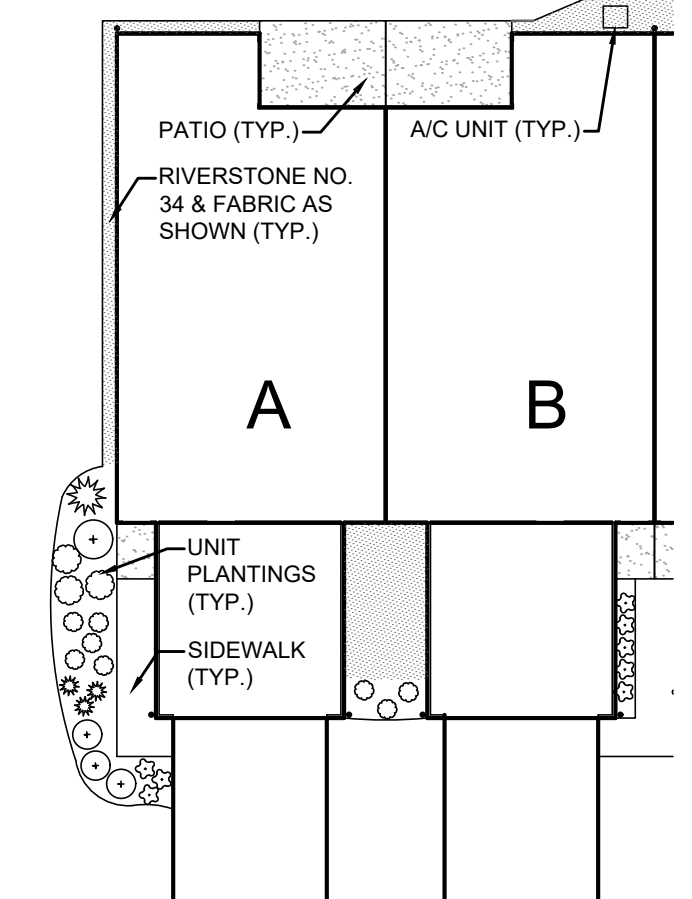

TYPE 10 BREEZEWOOD LANDSCAPE PLAN

TYPICAL UNIT LANDSCAPE PLANS

SCALE: 1"=20'

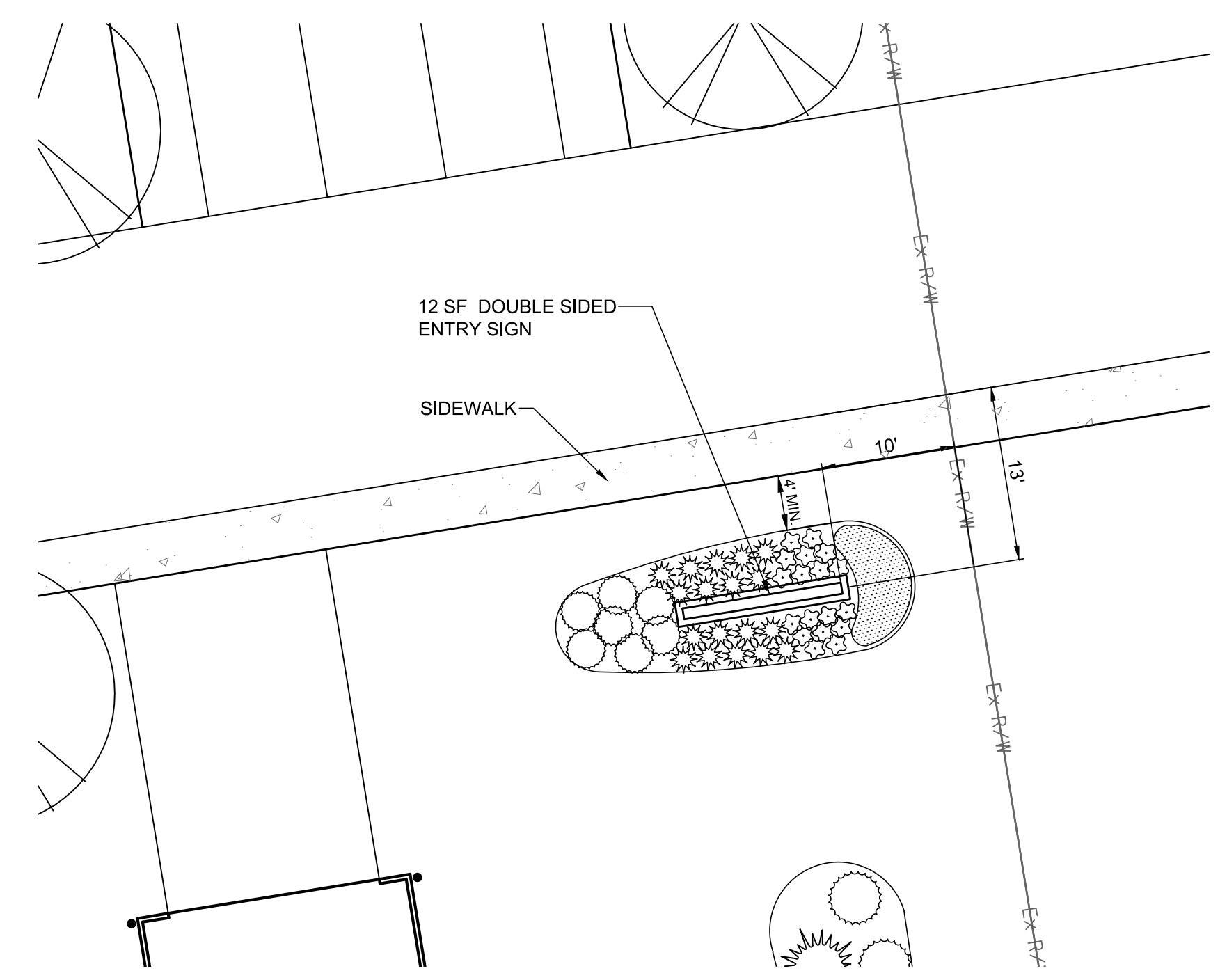

ENTRY SIGN LANDSCAPE PLAN

SCALE: 1"=10'

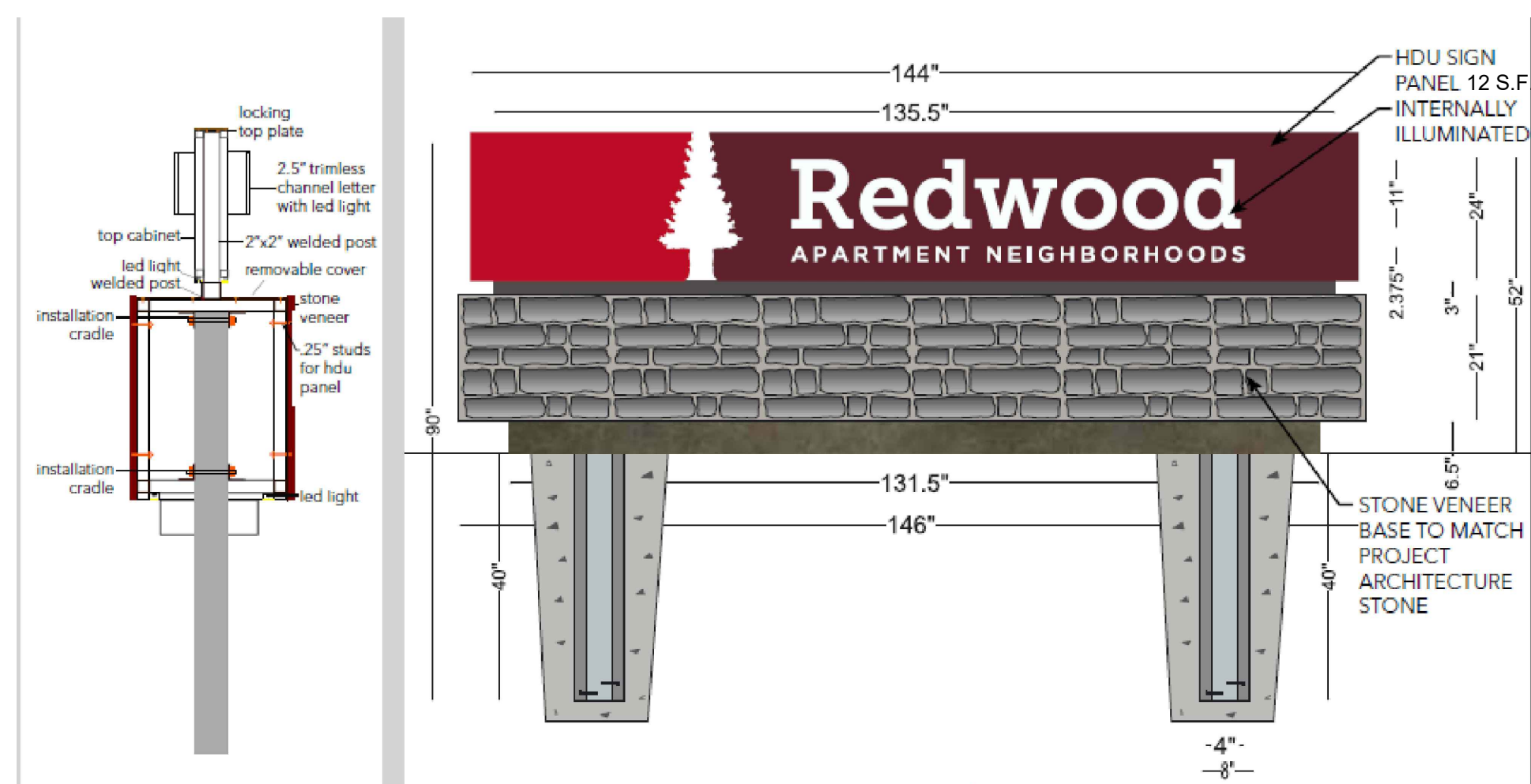

NOTES  
1. SIGN SHALL BE DOUBLE SIDED, INTERNALLY ILLUMINATED AND LOCATED PERPENDICULAR TO THE RIGHT OF WAY.

MAIN ENTRY SIGN

NOT TO SCALE

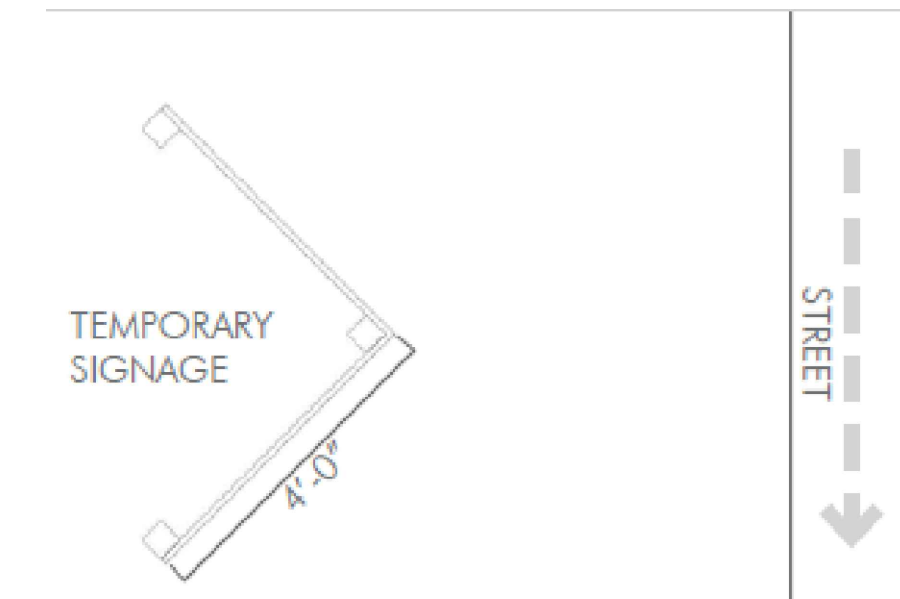

- 0.5"x4"x8' MDO painted PMS 925C on both sides with white premium vinyl lettering applied to face
- 2.4"x4"x96" posts painted 925C
- 3/4"x10"x10" MDO routed logo attached to face of sign to be painted PMS 7627C both sides with white premium vinyl letters on face

SIGN ELEVATION VIEW



SIGN PLAN VIEW

TEMPORARY SALES SIGN

NOT TO SCALE

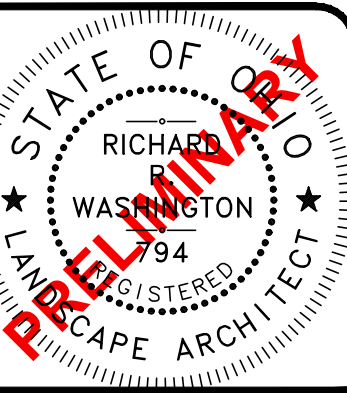

Richard Washington, License #754  
Expiration Date 12/31/2020

your trusted advisor  
consultants  
engineers  
architects  
planners

ISSUED FOR:	PRELIM SET	NO	REVISION	DATE
ISSUE DATE:	06/19/20			
SCALE:	AS SHOWN			
DESIGNED BY:	RW			
DRAWN BY:	RW			
CHECKED BY:	CC			

CHARDON 7TH AVE  
7TH AVE, CHARDON, OH, GEauga COUNTY  
REDWOOD - 7510 EAST PLEASANT VALLEY ROAD  
INDEPENDENCE, OH 44131

LANDSCAPE DETAILS

PROJECT NO:	200623
DISCIPLINE:	LANDSCAPE
SHEET NAME:	L-3
SHEET OF:	3 OF 3